



Wraysbury Drive Laindon, Basildon, SS15 4HY Asking Price £425,000

Nestled in the sought-after area of Wraysbury Drive, Steeple View, Laindon, this impressive FOUR bedroom detached house presents an excellent opportunity for those looking to create their dream home. Boasting four spacious bedrooms, this property is perfect for families or those who desire extra space. The house features two inviting reception rooms, providing ample room for relaxation and entertaining guests.

Convenience is at the forefront, ensuring that morning routines and family life run smoothly. There is a family bathroom, en suite to master bedroom & a ground floor wc.

One of the standout features of this home is the off-street parking, which offers ease and security for your vehicles. Additionally, the garage provides further storage options or the potential for a workshop, catering to various needs.

This house is ready for you to put your own stamp on it, allowing you to personalise the space to reflect your unique style and preferences. Whether you envision modern updates or a more traditional aesthetic, the possibilities are endless.

In summary, this detached house on Wraysbury Drive is a fantastic opportunity for buyers seeking a spacious family home in a desirable location. With its generous living spaces, convenient amenities, and potential for personalisation, this property is not to be missed.

- ASKING PRICE £425,000
- READY TO PUT YOUR OWN STAMP ON
- CHAIN FREE
- FOUR BEDROOMS
- EN SUITE TO MASTER
- 2 RECEPTION ROOMS
- OFF STREET PARKING
- GARAGE
- POPULAR STEEPLE VIEW LOCATION
- NEARBY TO LOCAL AMENITIES & MAJOR ROAD LINKS

Viewing

Please contact our Sales Office on 01268 730707 if you wish to arrange a viewing appointment for this property or require further information.



Floor Plan

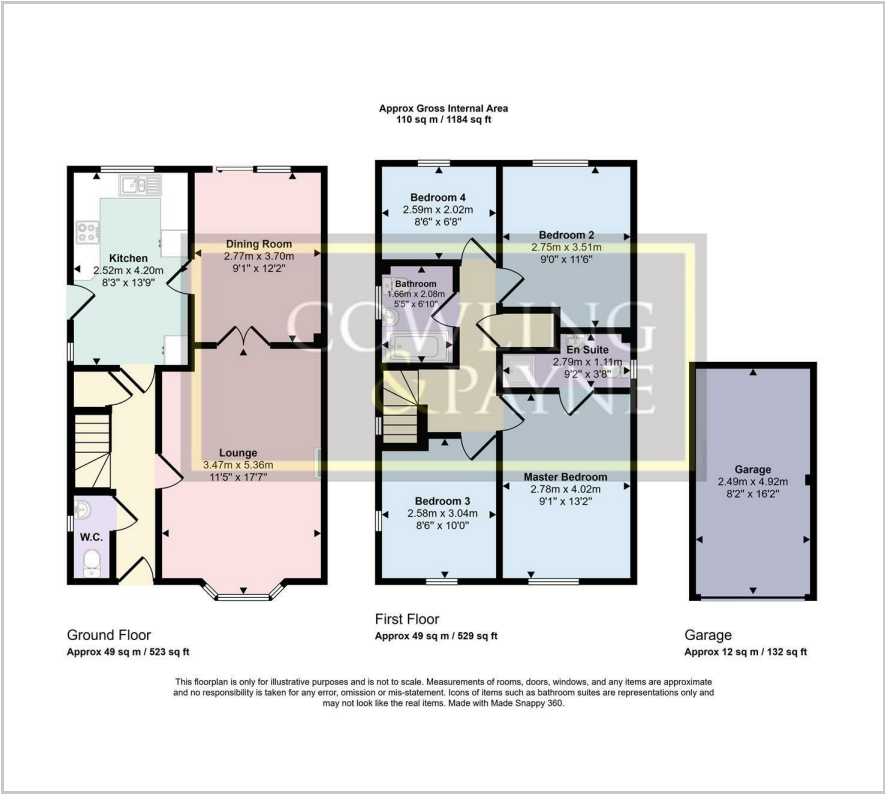

Area Map



Energy Efficiency Graph



These particulars, whilst believed to be accurate are set out as a general outline only for guidance and do not constitute any part of an offer or contract. Intending purchasers should not rely on them as statements of representation of fact, but must satisfy themselves by inspection or otherwise as to their accuracy. No person in this firms employment has the authority to make or give any representation or warranty in respect of the property.